

Arcus Powder Tanker  
 Overall Length 15.289m  
 Overall Width 2.500m  
 Overall Body Height 2.704m  
 Min Body Ground Clearance 0.419m  
 Track Width 2.450m  
 Lock to lock time 4.50s  
 Kerb to Kerb Turning Radius 6.670m

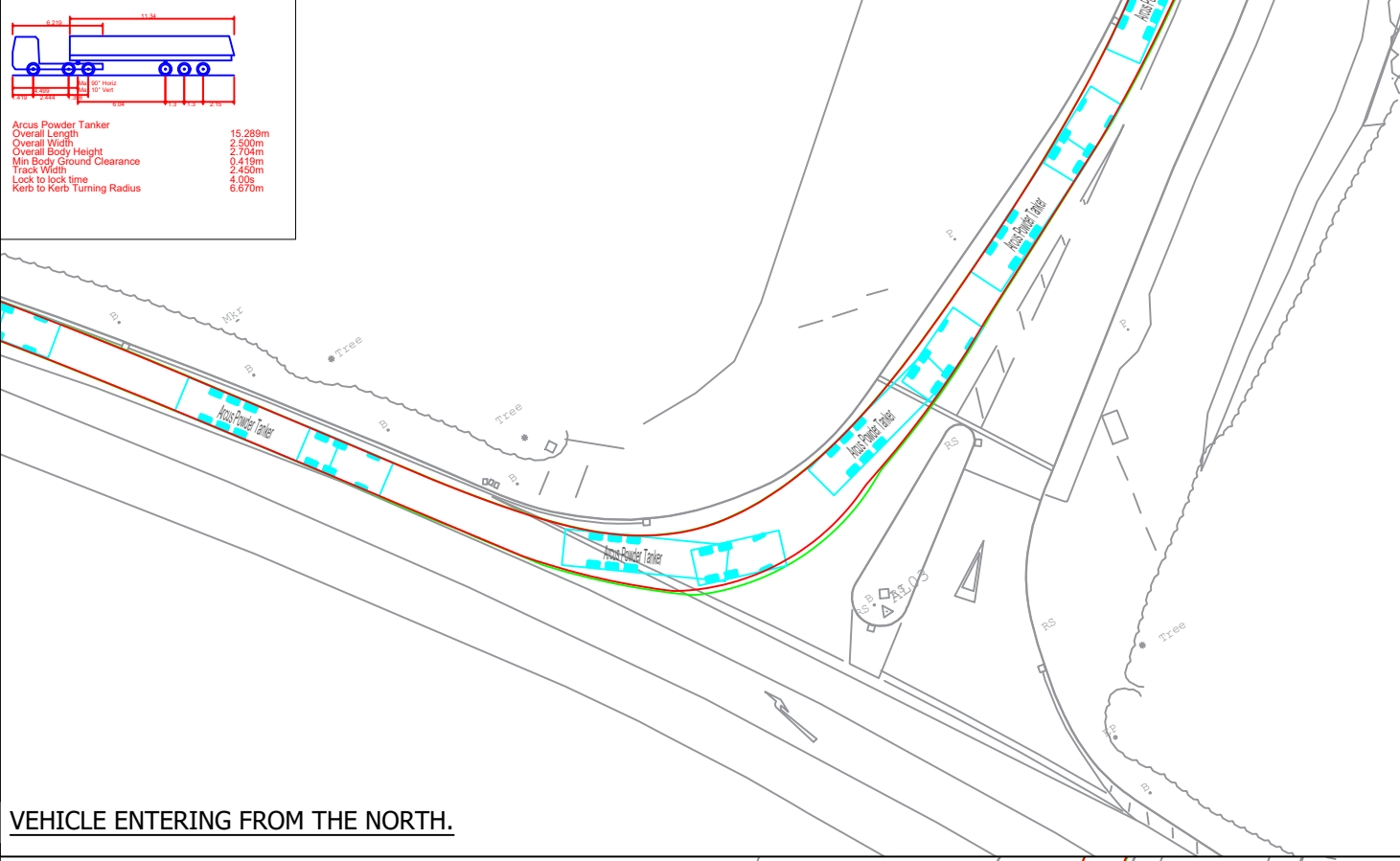

VEHICLE ENTERING FROM THE NORTH.

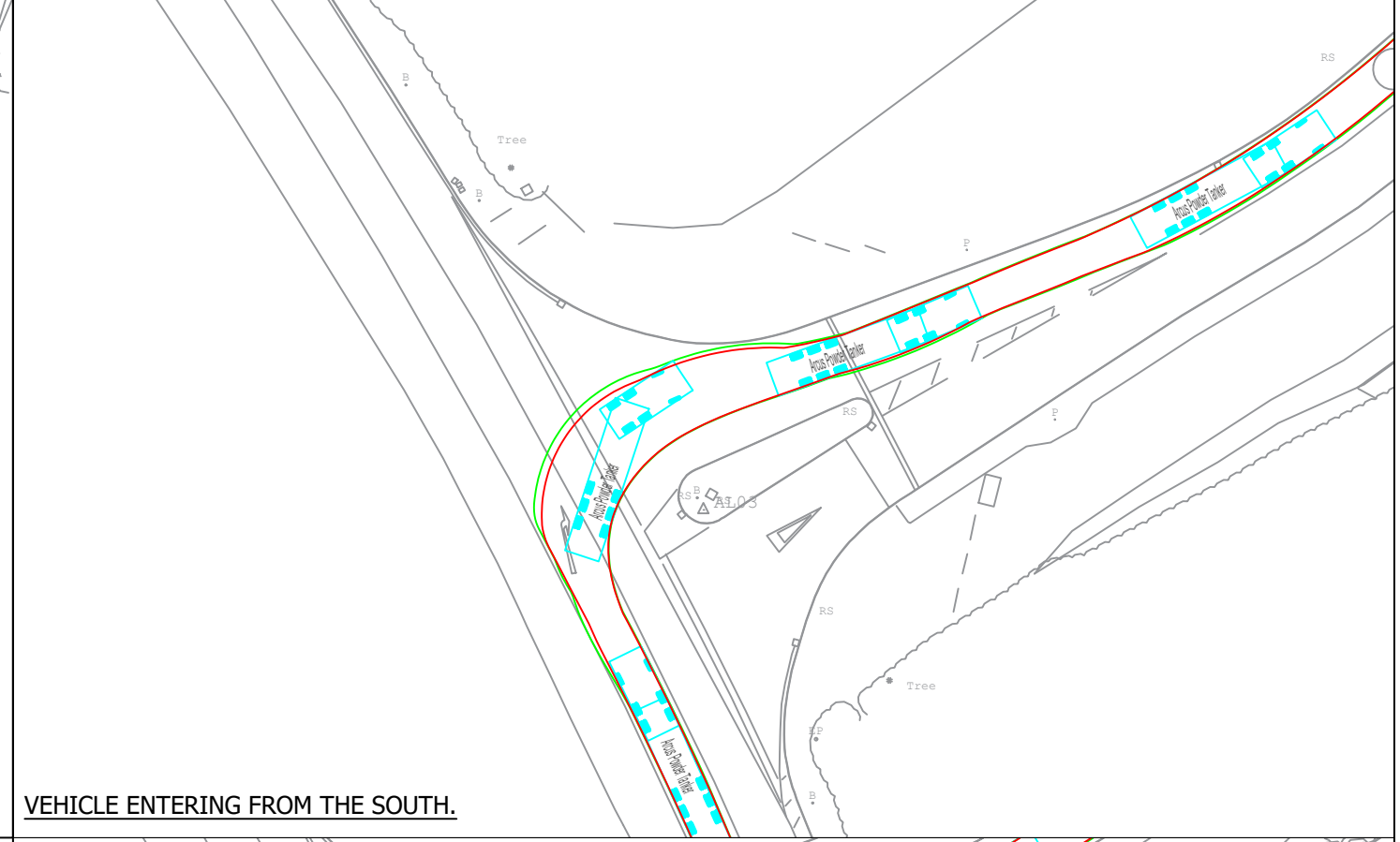

VEHICLE ENTERING FROM THE SOUTH.

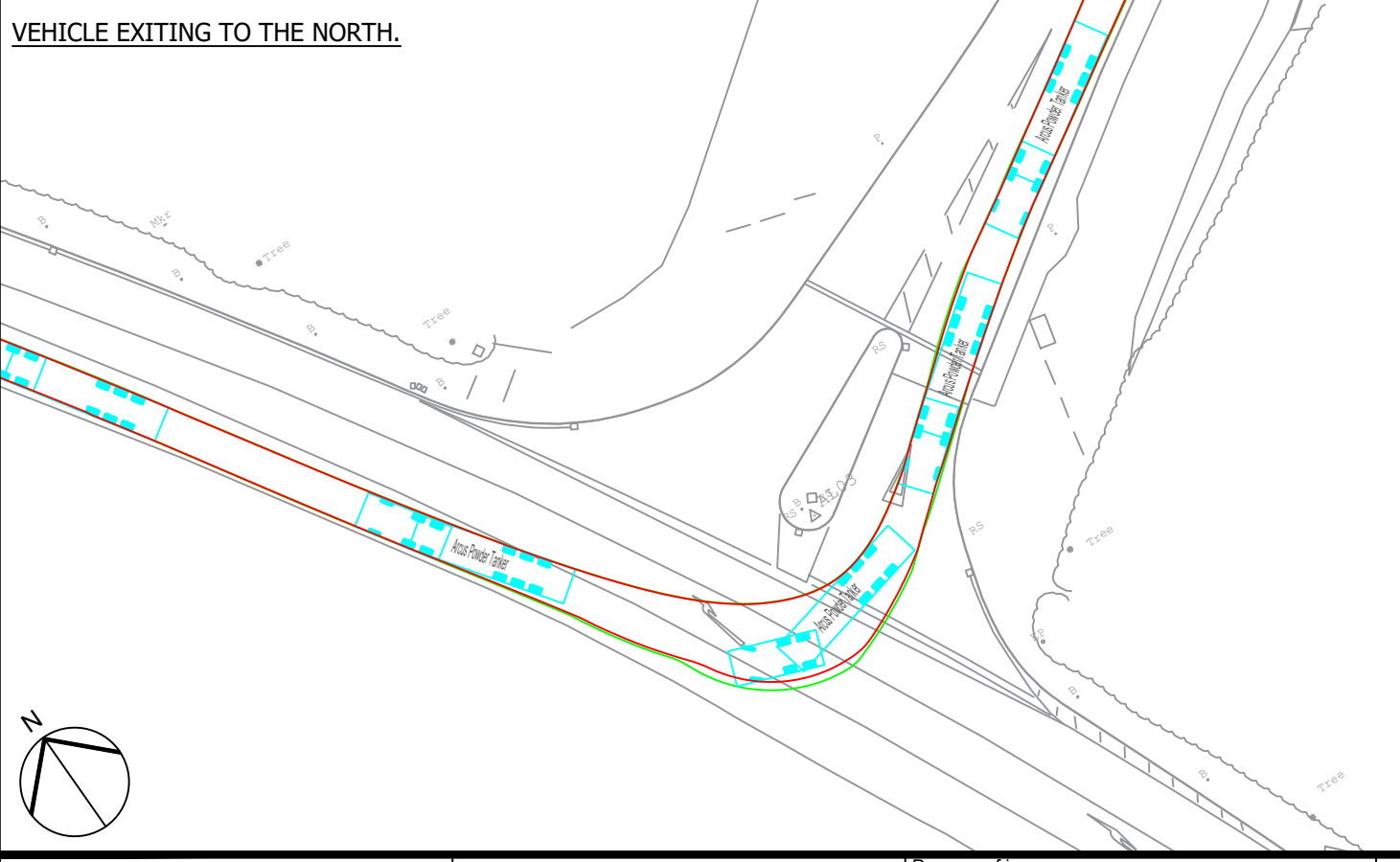

VEHICLE EXITING TO THE NORTH.

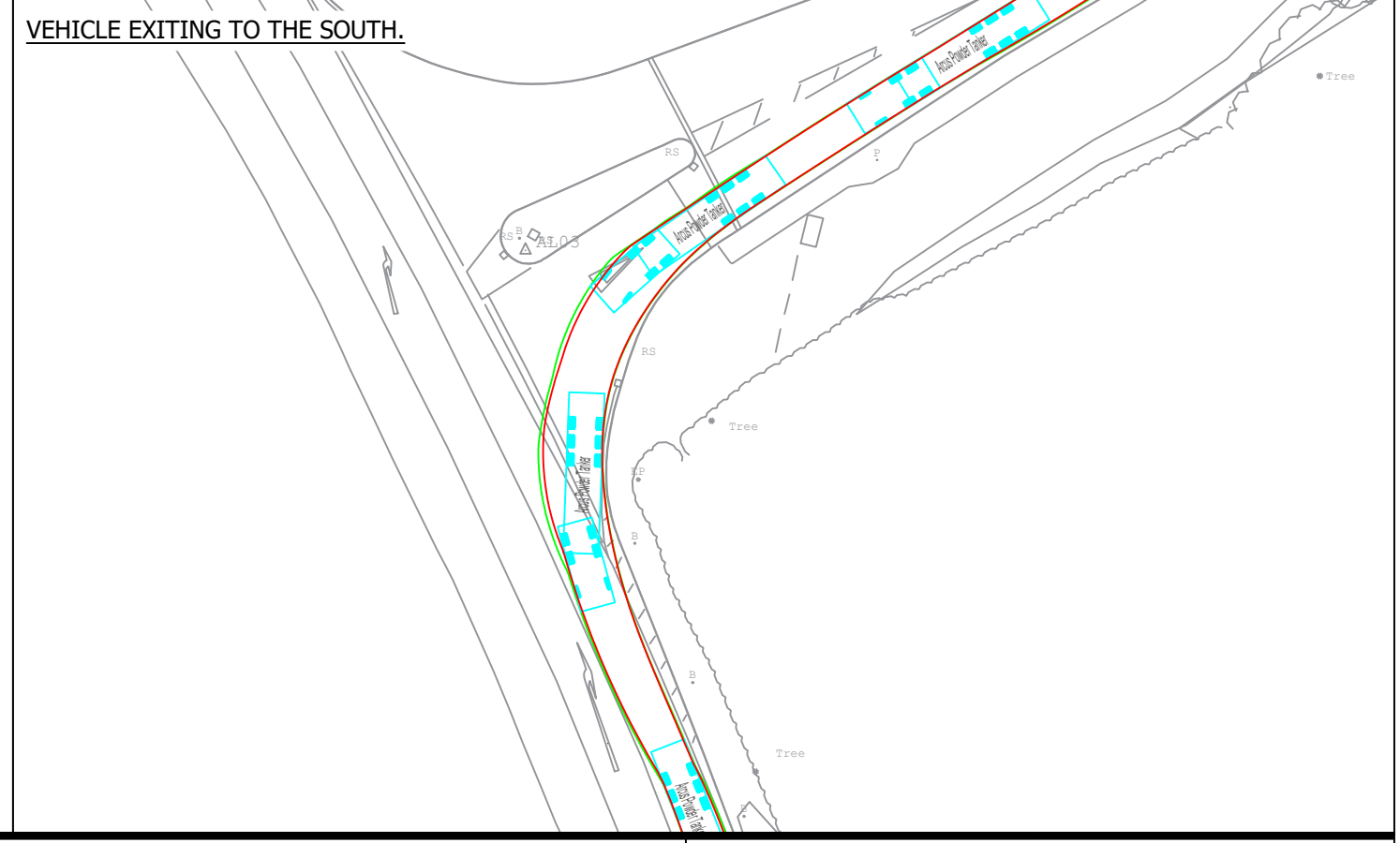

VEHICLE EXITING TO THE SOUTH.

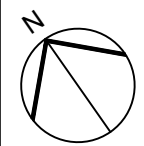

Plot Date : 01 February 2023 17:10:19  
 File Name : \\UKSPRDGIS\F501\DATA\ARCUS\GIS-CAD\4092 LOUND ASH EXTRACTION\01-WORKING\01\_01-DRAWINGS\4092-DR-P-0003\_P1

Project Title	RET福德 CIRCULAR ECONOMY PROJECT
Client	LOUND HIVE LTD

Drawing Title	SWEPT PATH ANALYSIS A638 / SITE ACCESS JUNCTION POWDER TANKER ASSESMENT
---------------	---

Purpose of issue <b>PRELIMINARY</b>			
Designed CR	Drawn RC	Checked FO	Approved FO
Arcus Internal Project No. 4092		Date 01/02/23	
Scale @ A3 1:500			

THIS DOCUMENT HAS BEEN PREPARED IN ACCORDANCE WITH THE SCOPE OF ARCUS' APPOINTMENT WITH ITS CLIENT AND IS SUBJECT TO THE TERMS OF THAT APPOINTMENT. ARCUS ACCEPTS NO LIABILITY FOR ANY USE OF THIS DOCUMENT OTHER THAN BY ITS CLIENT AND ONLY FOR THE PURPOSES FOR WHICH IT WAS PREPARED AND PROVIDED	
Drawing Number 4092_DR_P_0006	Rev -

**Arcus Consultancy Services**  
 7th Floor  
 144 West George Street  
 Glasgow, G2 2HG  
 Tel: +44 (0)141 221 9997  
 Fax: +44 (0)141 221 5610  
[www.arcusconsulting.co.uk](http://www.arcusconsulting.co.uk)

